

FIBER OPTIC CENTER BURST POUCH MIXING INSTRUCTIONS

FIBER OPTIC CENTER

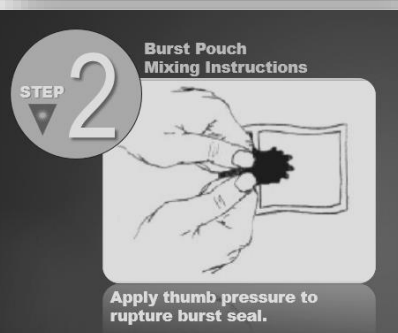

Step 1: Roll one end of the pouch toward the burst seal/sealed center dividing Part A and Part B. Roll the side that has the most material in it.



Step 2: Use your thumbs to apply pressure and push on the material towards the seal to rupture the burst seal.

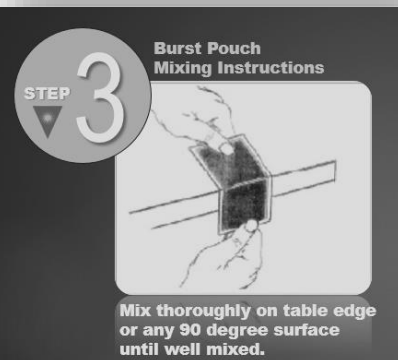

Step 3: Use a table edge to mix the resin and hardener (Part A and Part B) or a roller. We recommend counting 25 passes on the table edge to achieve a uniform color and mix. Counting the number of passes (instead of seconds or minutes) helps to ensure a uniform mixture. In each pass, methodically push all the material to one end of the package, then to the other end. Even if the seal is not burst open all the way, it will be burst enough for the material to free flow through the opening.

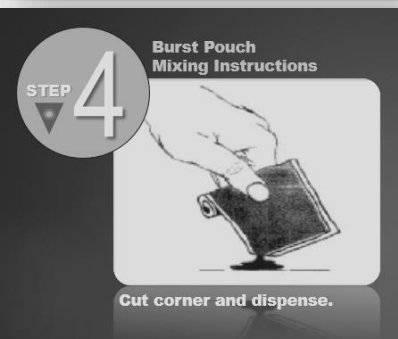

Step 4: Cut the corner of the package and squeeze the mixed epoxy into a dispensing syringe.

Contact Us

(800) IS-FIBER | (800) 473-4237 . Direct 508-992-6464 . Email: sales@focenter.com
23 Centre Street, New Bedford, MA 02740-6322 USA